

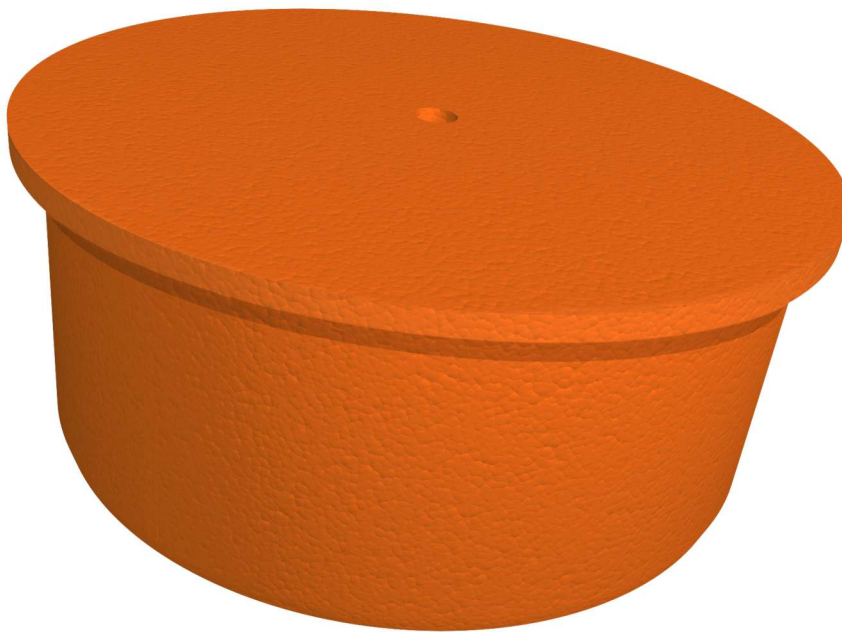

RDLM6/A



*Vianova electromagnets
Special series for custom application
110Vcc, 1.3A, 2600kg max.*

ELECTROMAGNETS



ELECTROMAGNET RDLM6/A

MAGNET DIMENSIONS

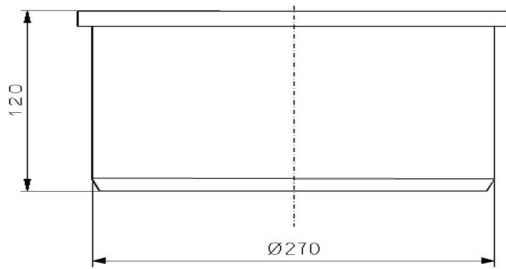

Vianova Magnets, continuously developed in the past 30 years, have reached high efficiency and high durability levels.

An example of a newly developed magnet is the RDLM6/A, capable of fulfilling the most demanding working requirement.

This model is especially designed for magnetic beams, where high tangent forces and particular arrangements are required.

AXIAL LOAD CAPACITY ACCORDING TO PLATE THICKNESS

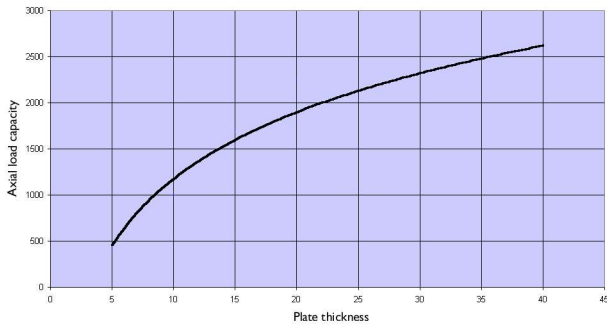

Technical characteristics:

Voltage	110 Vcc
Current	1,36 Amps
Power	150 Watts
Maximum weight	2600 Kg
Protection degree	IP65

TANGENT LOAD CAPACITY ACCORDING TO PLATE THICKNESS

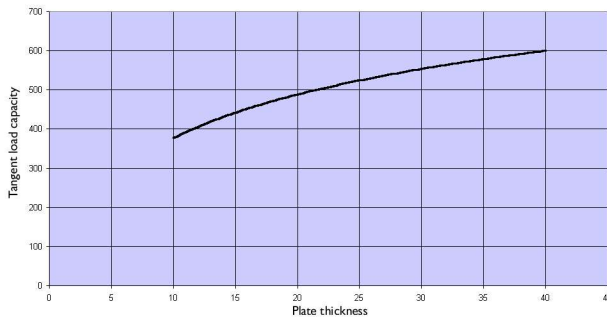

VIANOVA Plants Via Puccini, 13 33040 Campolongo al Torre - Udine - Italy

Tel. +39 (0)431 99005 Fax. +39 (0)431 973496 Email: info@vianovaplants.com <http://www.vianovaplants.com>