

# Orbiter OH 1250

The orbiter is a rotating high performance jetting tool for surface treatment and concrete deep removal. It is designed to be attached to traversing units, building machines and robots. It consists of the carrier frame, the hydraulic drive, the rotating mechanism, the nozzle receiver and the nozzle lance.

## **Special advantages**

- ▶ Sturdy construction suitable for building sites
- ▶ All-purpose construction
- ▶ High efficiency
- ▶ Adjustable in height and rotating surface for various working intensities

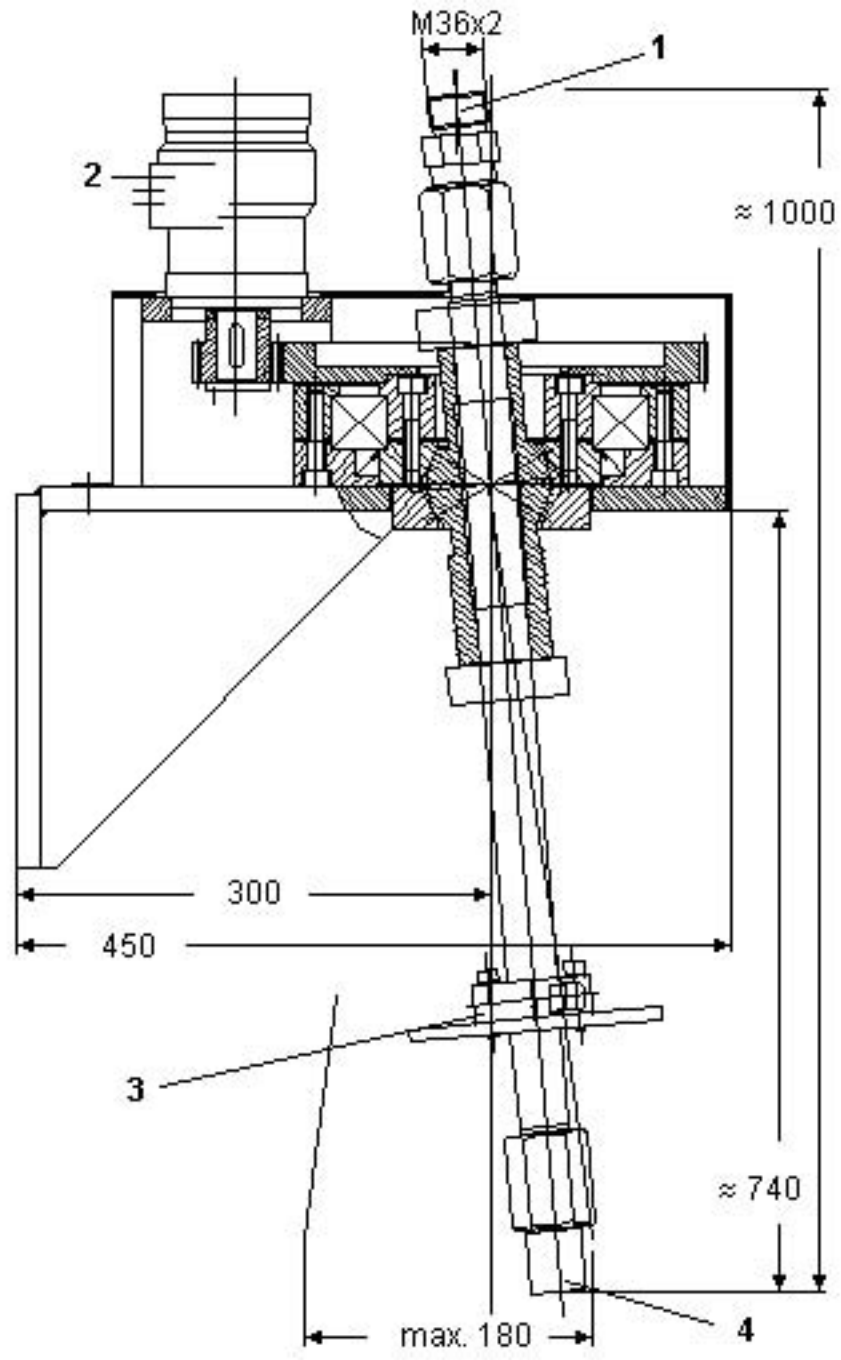

1. hose connection
2. hydraulic motor
3. splash guard
4. nozzle

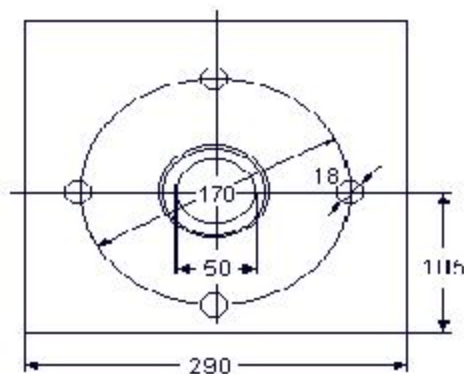

## Technical data

Part-No.:	001.0864
Operating pressure	max. 1250 bar
Flow rate	max. 400 l/min
Operating speed	max. 150 °/min
Speed hydraulic motor	max. 800 °/min
Hydraulic oil pressure	max. 20 bar
Hydraulic oil flow	max. 40 l/min
Hose connection	M 36 x 2 - 24°DK
Weight	approx. 86 kg
Applicable nozzles	form 1 and form 8